

HYDRAULIC *BESKO* MINI POWER PACKS

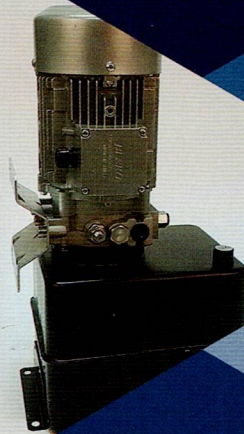

DUKIN INDUSTRIES CO., LTD

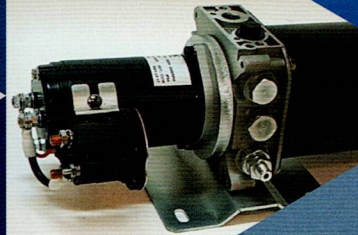
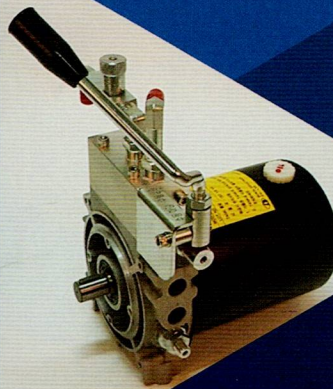
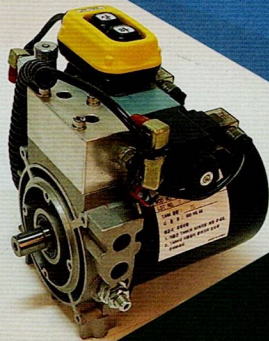
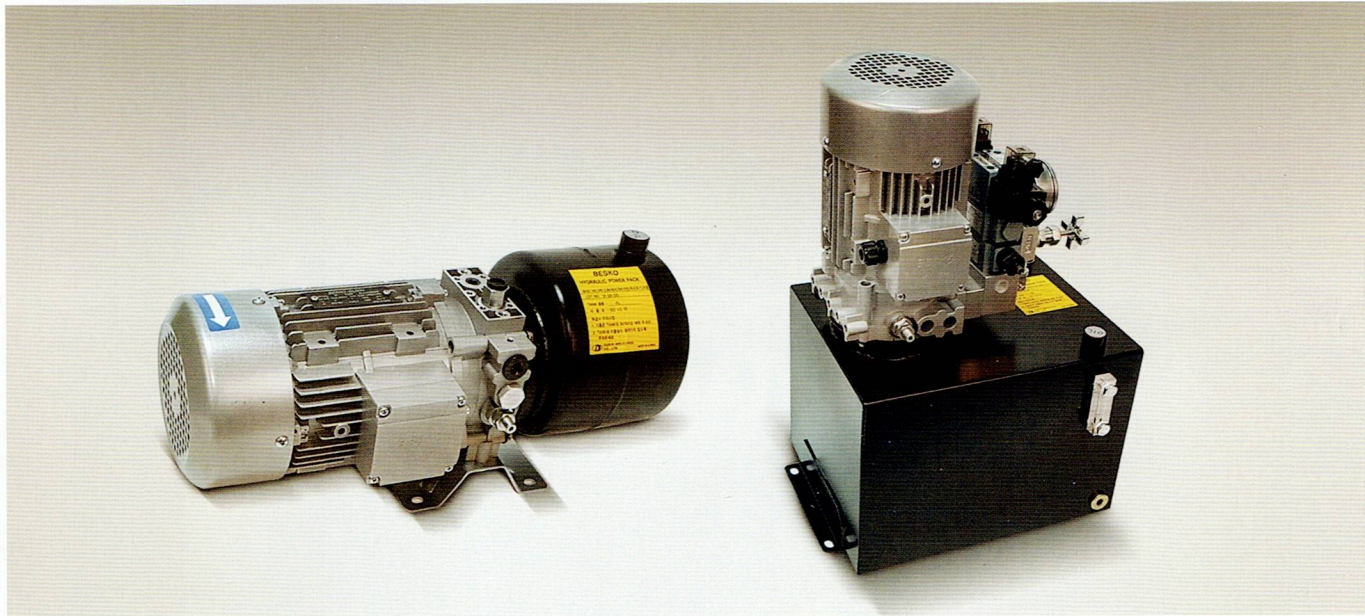

CIRCULAR TYPE(원형타입)

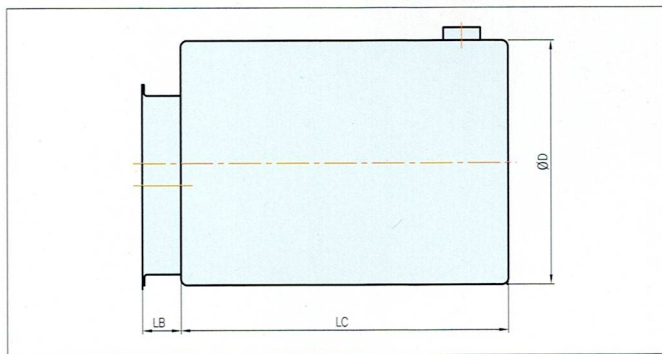

SQUARE TYPE(사각타입)

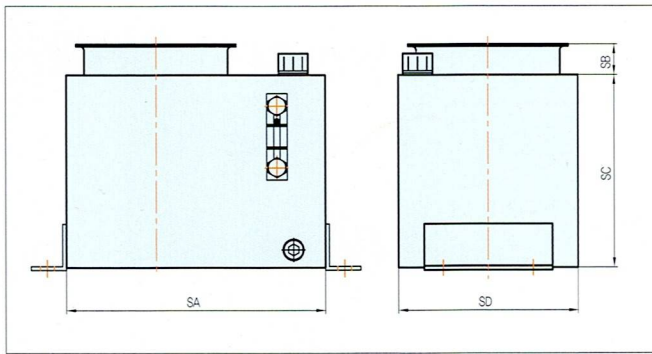

■ DIMENSIONS

mm	CIRCULAR(원형) OIL TANK - CAPACITY (L)								REMARK
	1L	2L	4L	5L	6L	8L	10L	11L	
LB	0	0	30	30	30	30	30	30	
LC	140	170	150	190	220	290	375	415	
ØD	139	139	190	190	190	190	190	190	

주의 - VERTICAL TYPE (4L) 이상

■ DIMENSIONS

mm	SQUARE[사각] OIL TANK - CAPACITY (L)						REMARK
	12L	15L	20L	25L	30L	40L	
SA	285	285	380	380	380	400	
SB	30	30	30	30	30	30	
SC	180	230	200	240	270	300	
SD	235	235	280	280	280	340	

※상기 이외의 특수 사양은 언제든지 주문제작 가능합니다.

CIRCULAR TYPE(원형타입)

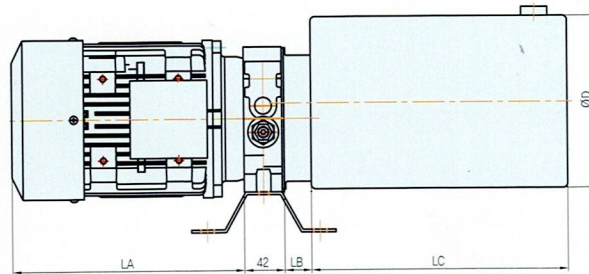
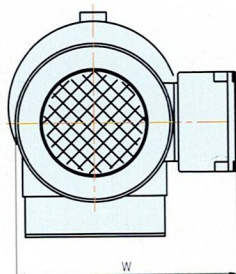

HORIZONTAL TYPE(수평형)

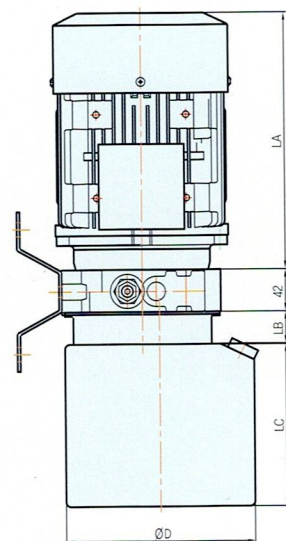

VERTICAL TYPE(수직형)

CIRCULAR TYPE(원형타입)

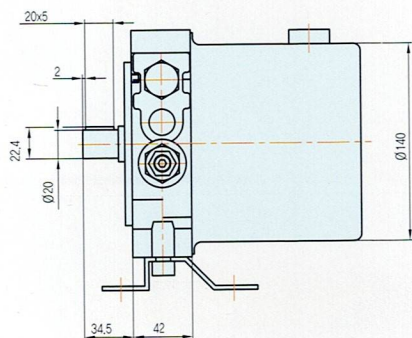

BELT&COUPLING DRIVEN TYPE(엔진타입)

SQUARE TYPE(사각타입)

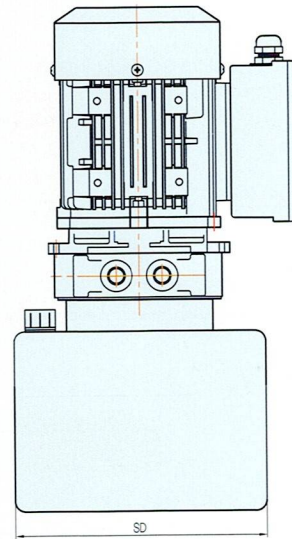
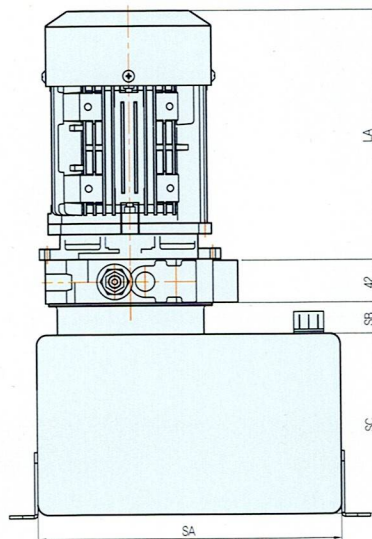

VERTICAL TYPE(수직형)

■ DIMENSIONS

■ DIMENSIONS									
mm	AC-MOTOR								REMARKS
	1 PHASE				3 PHASE				
	0.5KW	0.75KW	1.5KW	2.2KW	0.75KW	1.1KW	1.5KW	2.2KW	
W	170	230	250	250	190	205	205	205	
LA	185	250	270	270	240	265	265	275	

■ DIMENSIONS

mm	DC-MOTOR						
	DC 12V			DC 24V			DC 48V
	500W	800W	1200W	500W	800W	2000W	2000W
W	110	110	180	110	110	180	180
LA	156	156	161	156	156	161	161

HYDRAULIC MINI POWER PACKS . . . **BESKO**

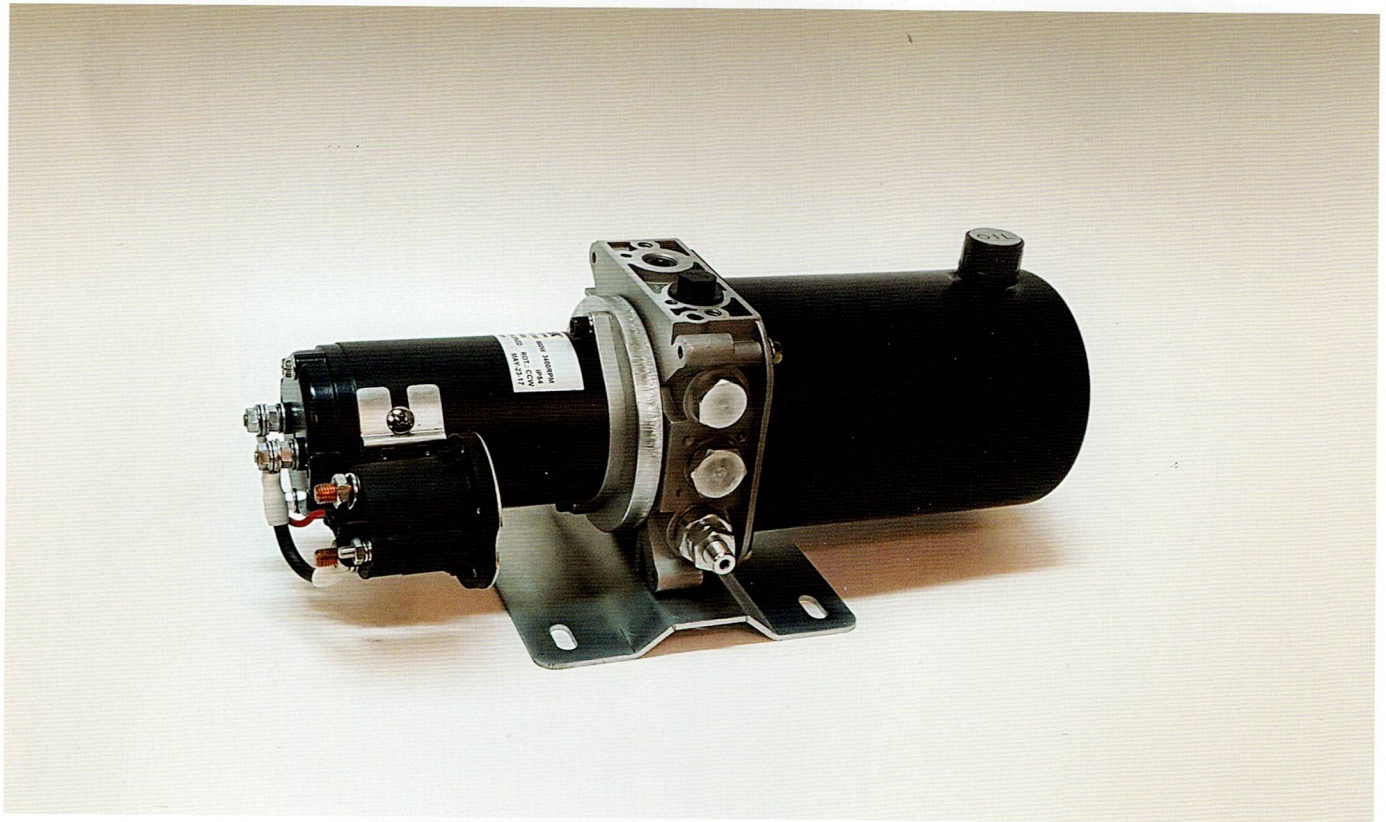

HORIZONTAL TYPE (DC-CENTER BLOCK SMALL)

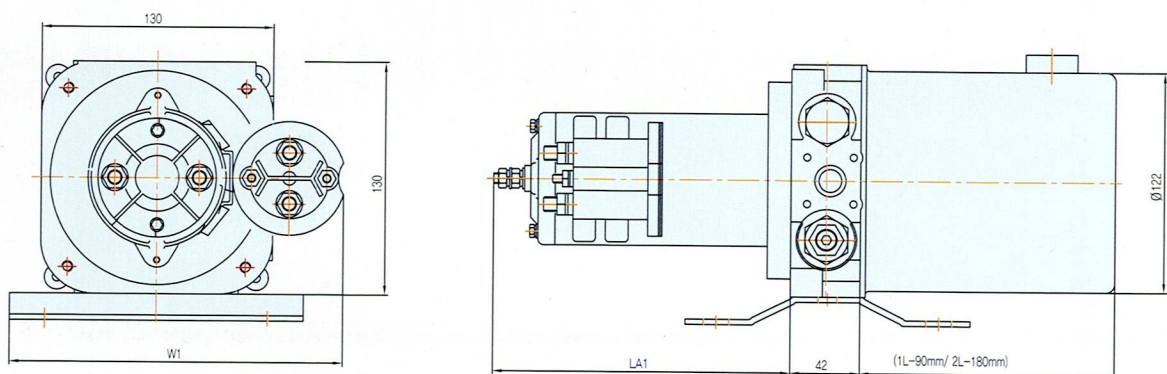

■ DIMENSIONS

mm	DC-MOTOR						
	DC 12V			DC 24V			DC 48V
	500W	800W	1200W	500W	800W	2000W	2000W
W1	195	195	215	195	195	215	215
LA1	156	156	161	156	156	161	161

■ GEAR PUMP CAPACITY

DISPLACEMENT (CC/REV)				
0.5	0.8	1.2	1.7	2.0
2.5	3.5	4.3	5.0	5.7
6.5	7.8	9.8		

MOUNTING BRACKET

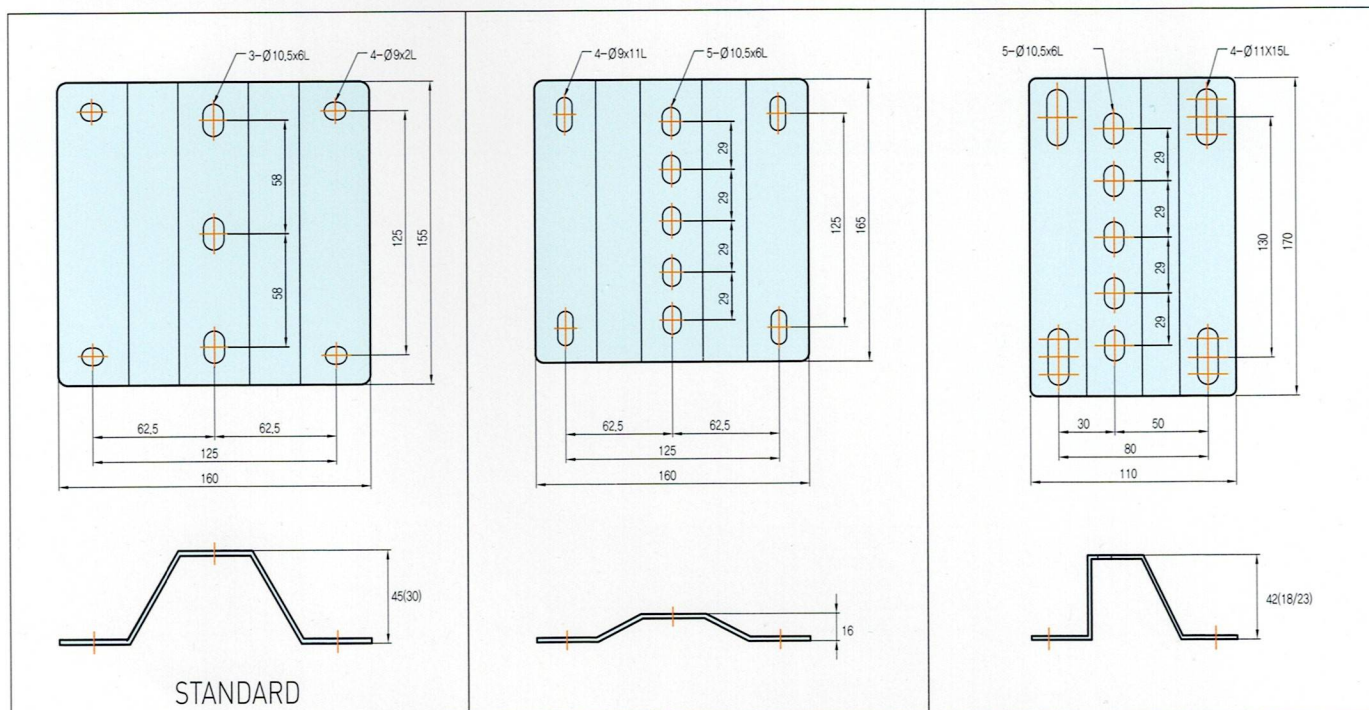
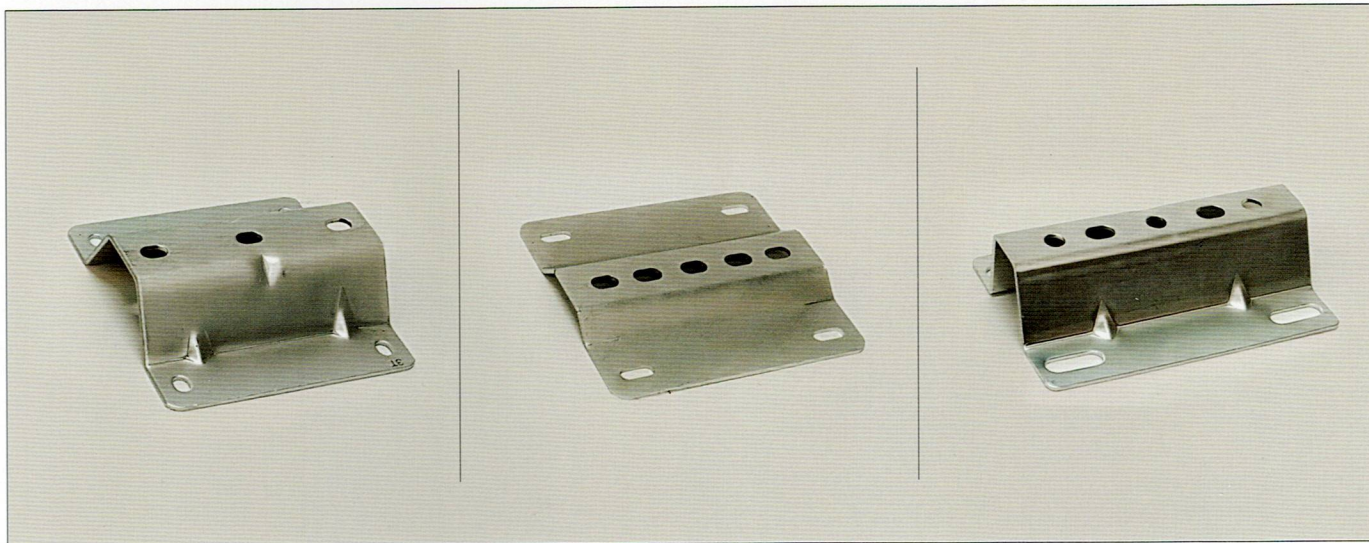

BESKO



주식회사 득인기공

DUKIN INDUSTRIES CO., LTD.

-
- 본사 . 공장 : 경북 칠곡군 왜관읍 공단로4길 17-9
TEL : 054-975-0700, FAX : 054-975-0998
E-MAIL : dukin@dukin-besko.co.kr
HOMEPAGE : www.besko.co.kr
 - 서울 영업소 : 서울특별시 구로구 경인로53길 90, 1703호(STX W-TOWER)
TEL : 02-704-5101, FAX : 02-704-2020
 - 부산 영업소 : 부산광역시 사상구 과감로 (과법동)
부산산업용품유통상가 16동 107호
TEL : 051-319-0760, FAX : 051-319-0763
 - 대구 영업소 : 대구광역시 북구 유통단지로16 (산격동)
산업용재관 4동 15호
TEL : 053-604-4124, FAX : 053-604-1768

 - HQ & FACTORY : #17-9, GONGDAN-RO 4-GIL, WAEGWAN-EUP, CHILGOK-GUN,
GYEONG BUK, REPUBLIC KOREA
TEL : 82-54-975-0700, FAX : 82-54-975-0998
E-MAIL : dukin@dukin-besko.co.kr
HOMEPAGE : www.besko.co.kr
 - SEOUL BRANCH : #1703, STXW-TOWER, 90, GYEONGIN-RO 53-GIL, GURO-GU,
SEOUL, REPUBLIC OF KOREA
TEL : 82-2-704-5101, FAX : 82-2-704-2020
 - BUSAN BRANCH : #107, 16DONG, BUSAN INDUSTRIAL SUPPLIES MAKET, #37,
GWAEGAM-RO, SASANG-GU, BUSAN, REPUBLIC OF KOREA
TEL : 82-51-319-0760, FAX : 82-51-319-0763
 - DAEGU BRANCH : #15, 4DONG, DAEGU INDUSTRIAL MATERIAL COMPLEX, #16,
YUTONGDANJI-RO, BUK-GU, DAEGU, REPUBLIC OF KOREA
TEL : 82-53-604-4124, FAX : 82-53-604-1769